



**FEEL THE HEAT!**

## Cargo Rack for CanAm Maverick X3

Part # **01-2928 / 2929** Maverick X3 - All Models Black / Red

Congratulations on your purchase of the DragonFire Cargo Rack! Flats are inevitable and not fun. With this setup, you can bring a spare tire without sacrificing the storage space. Be sure to check out the full line of DragonFire Accessories for your CanAm vehicle at your local authorized dealer or online at <http://www.DragonFireRacing.com>

**Tire tie-down straps are not provided.**



- Read and understand these instructions before installing product
- Do not overload rack as vehicle may become unstable
- Installation may scratch powder coat or paint
- Never stand or allow passengers on top of rack
- This product is rated for a load of no more than 150lbs or 68kg
- Do not use product if there are any signs of damage

### Disclaimer

Off road activities can be hazardous and could lead to injury, dismemberment, paralysis and death. No warranty of representation is made as to the products ability to protect the user from any injury or death. The user assumes that risk. The acceptance and /or use of this merchandise purchased from DragonFire by the customer hereby shall release DragonFire from any and all liability pertaining to the use of such merchandise.

**Pre-installation:** Lay out components and compare to list and images.

Part & Hardware List					
ITEM	QTY	SIZE	LENGTH	TYPE	STEP USED
P1	1	-	-	Cargo Rack	8
P2	1	-	-	Mount Plate Driver	4
P3	1	-	-	Mount Plate Passenger	7
P4	1	-	-	Clamp Block Driver	11 & 12
P5	1	-	-	Clamp Block Passenger	11 & 12
P6	4	-	50 - 70 mm	Hose Clamps	11 & 12
P7	4	1/4"-20	1-1/2"	Hex Bolt	5 - 7
P8	8	1/4"	-	Flat Washer	5 - 7
P9	4	1/4"	1/2"	Aluminum Spacer	5 - 7
P10	4	1/4"-20	-	Nylon Locknut	5 - 7
P11	2	7/16"-20	3/4"	Hex Bolt	8
P12	2	7/16"	-	Flat Washer	8
P13	4	7/16"	-	Nylon Washer	8

Tools Required
T40 Torx
7/16" Wrench & Socket
5/8" Socket
5/16" Nut Driver
10mm Wrench
13mm Wrench
Ratchet

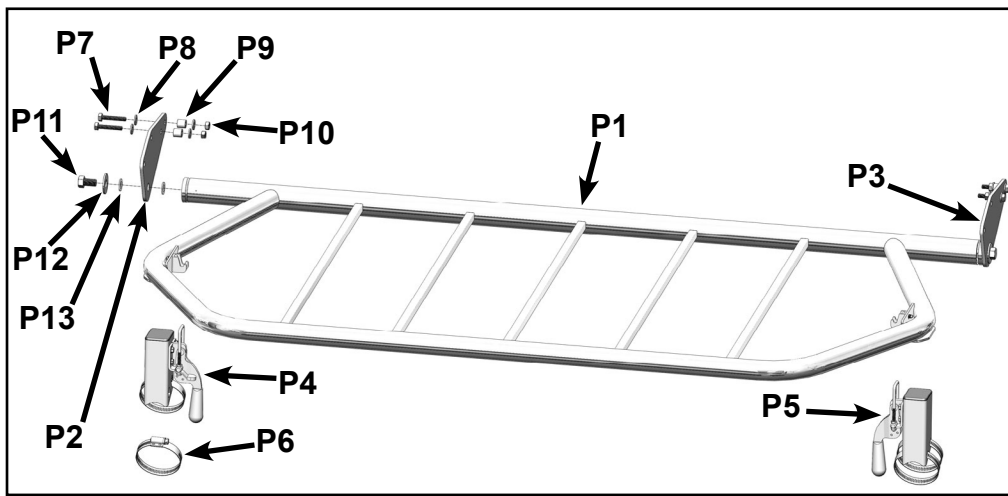

**Note:** An assistant is needed to hold the Cargo Rack in place during installation.

**Step 1:** Place vehicle on a flat and level surface. Place gear selector in "Park" and remove keys from the ignition.

**Step 2:** Locate the Torx bolts on the side of the C-Pillar. (Figure A)

**Step 3:** Remove 4 Torx bolts and nuts. Retain hardware for later use. (Figure B)

**Step 4:** Locate the Mount Plate Driver (P2). Align hole pattern of plate to hole pattern of vehicle frame. The logo should be facing away from the vehicle. (Figure C)



**Step 5:** Place 1/4" bolts (P7) with washers (P8) through the two front-most holes of mount plate.

**Step 6:** Place spacers (P9) onto bolts (P7). Insert bolts through holes of vehicle frame. (Figure D) Then loosely install with washers (P8) and nuts (P10).

**Step 7:** Loosely install factory bolts and nuts retained from Step 3. (Figure E) Repeat 4 to 7 for opposite side, Mount Plate Passenger (P3).

**Step 8:** Align holes on the Cargo Rack (P1) to holes on mount plates. (Figure F) Place 7/16" bolt (P11) through flat washer (P12), Nylon washer (P13), and hole of mount plate. Place another Nylon washer (P13) onto the bolt between mount plate and Cargo Rack. Loosely install hardware to Cargo Rack.



**Step 9:** Torque the 1/4" hardware to 9 ft-lbs and factory hardware to factory torque specifications. Repeat for opposite side.

**Step 10:** Torque the 7/16" hardware on both sides (40 to 55 ft-lbs) and then verify to see if rack can rotate freely.

**Note:** Medium strength thread-locker may be used if bolts regularly back out.

**Step 11:** Install Clamp Block Driver (P4) using hose clamps (P6) with head assembly of hose clamp recessed inside rectangular tube. (Figure G)

**Step 12:** Position the block where the rack lays flat on the block. (Figure H) Tighten hose clamps until clamp block is fixed. Repeat for opposite side, Clamp Block Passenger (P5).

**Note:** If desired, trim ends of hose clamps for a cleaner look.

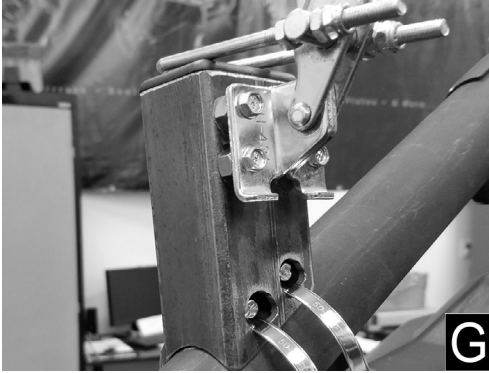

**Step 13:** If necessary, adjust length of U-bolt on toggle clamps to change its clamping force using the 10mm wrench.

**Step 14:** This completes installation. Time to ride and enjoy!

**ProTip:** Periodically check all hardware and re-tighten if needed.

For further assistance please contact us at [customerservice@dragonfireracing.com](mailto:customerservice@dragonfireracing.com) or 1-800-708-9803.